



**Dorset  
Council**

**Public Path Diversion  
and  
Definitive Map and Statement Modification Order**

**Town and Country Planning Act 1990, Section 257  
Wildlife and Countryside Act 1981, Section 53A(2)**

**Dorset Council (Footpath 9, Stalbridge)  
Public Path Diversion Order 2026**

This Order is made by Dorset Council ("the authority") under section 257 of the Town and Country Planning Act 1990 ("the 1990 Act") because it is satisfied that it is necessary to divert the footpath to which this Order relates in order to enable development to be carried out in accordance with planning permission granted under Part III of the Town and Country Planning Act 1990 namely: Erect Bio-secure Link Corridor and Ancillary Egg Packing/Staff Welfare Building (P/FUL/2025/04214)

This Order is also made under section 53A(2) of the Wildlife and Countryside Act 1981 ("the 1981 Act") because it appears to the authority that the County of Dorset definitive map and statement require modification in consequence of the occurrence of an event specified in section 53(3)(a)(i) of the 1981 Act, namely, the diversion (as authorised by this Order) of a highway hitherto shown or required to be shown in the map and statement.

**BY THIS ORDER:**

1. The footpath over the land shown by a bold black line on the attached map and described in Part 1 of the Schedule to this Order ("the Schedule") shall be diverted and the County of Dorset definitive map and statement shall be modified as provided below.
2. There shall be created to the reasonable satisfaction of Dorset Council an alternative highway for use as a replacement for the said footpath as provided in Part 2 of the Schedule and shown by bold black dashes on the attached map.
3. The diversion of the footpath shall have effect on the date on which Dorset Council certify that the terms of Article 2 above have been complied with, and upon the occurrence of that diversion the County of Dorset definitive map shall be modified by deleting from it the path or way referred to in Article 1 of this Order and the path or way referred to in Article 2 of this Order shall be added to it, and the definitive statement shall be modified as described in Part 3 of the Schedule.
4. The following works shall be carried out in relation to the highway described in Part 2 of the Schedule:
  - Create 2m gap in hedge at point C to allow access from highway at southern end
  - Construct minimum 1:12 slope from highway at point C

- Level surface where required
- Construct post and net fence alongside the new route between points C and H
- Create 2m gap at northern end at point H

[5. Mr Alex Frankpitt is hereby required to pay or the cost of carrying out the said works.

6. Where immediately before the date on which the footpath is diverted there is apparatus under, in, on, over, along or across it belonging to statutory undertakers for the purpose of carrying out their undertaking, the undertakers shall continue to have the same rights in respect of the apparatus as they then had.

## SCHEDULE

(The points specified relate to the map attached to the Order and their positions are identified by national grid references)

### Part 1

#### Description of site of existing path

##### Footpath 9, Stalbridge Parish:

- B - A From its junction with Footpath 8 at Point B (ST 7195 1698), south west through Middle Farm to the public highway at Point A (ST 7184 1680)  
(No recorded width)

### Part 2

#### Description of site of alternative highway

##### Footpath 9, Stalbridge Parish:

- J - H - G From its junction with Footpath 8 at Point J (ST 7186 1698) approximately 5  
- F - E - metres south to Point H (ST 7186 1697) then approximately 30 metres west  
D - C to Point G (ST 7184 1697) then approximately 80 metres generally south to  
Point F (ST 7185 1688) then generally south west for approximately 20  
metres to Point E (ST 7183 1687) approximately 47 metres west south west  
to Point D (ST 7179 1687) and then approximately 36 metres generally south  
on a minimum 1:12 slope to meet the public highway at Point C (ST 7179  
1683). Width 2.5m

### Part 3

#### Modification of Definitive Statement

##### Variation of particulars of path

##### Footpath 9, Stalbridge Parish:

###### **Delete:**

From: 719170 To: 718168

Path No 8, west of Church Close, south west to lane north of Mission Hall

###### **Add:**

From: ST 7186 1698 To: ST 7179 1683

From its junction with Footpath 8 at ST 7186 1698 approximately 5 metres south to ST 7186 1697 then approximately 30 metres west to ST 7184 1697 then approximately 80 metres generally south to ST 7185 1688 then generally south west for approximately 20 metres to ST 7183 1687 approximately 47 metres west south west to ST 7179 1687 and then approximately 36 metres generally south on a minimum 1:12 slope to meet the public highway at ST 7179 1683. Width 2.5m

Dated this 13<sup>th</sup> day of MARCH 2026



THE COMMON SEAL of  
DORSET COUNCIL  
was affixed in the presence of:-

*Jonathan M...*

193/26

Authorised signatory

**KEY:**

**UNAFFECTED FOOTPATHS**

**FOOTPATH TO BE DIVERTED**

**B** **A**

**PROPOSED FOOTPATH DIVERSION**

**J H G F E D C**

**GRID REFERENCES:**

- A ST 7184 1680
- B ST 7195 1698
- C ST 7179 1683
- D ST 7179 1687
- E ST 7183 1687
- F ST 7185 1688
- G ST 7184 1697
- H ST 7186 1697
- J ST 7186 1698

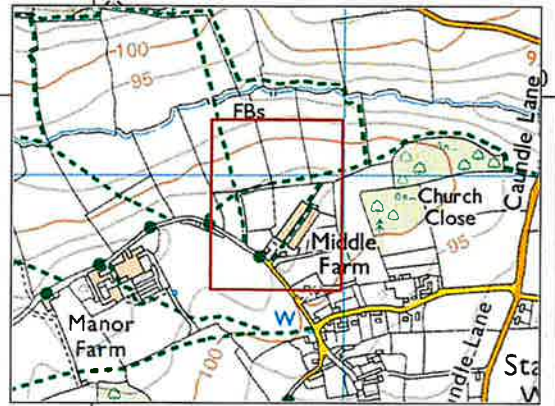

**STALBRIDGE PARISH**

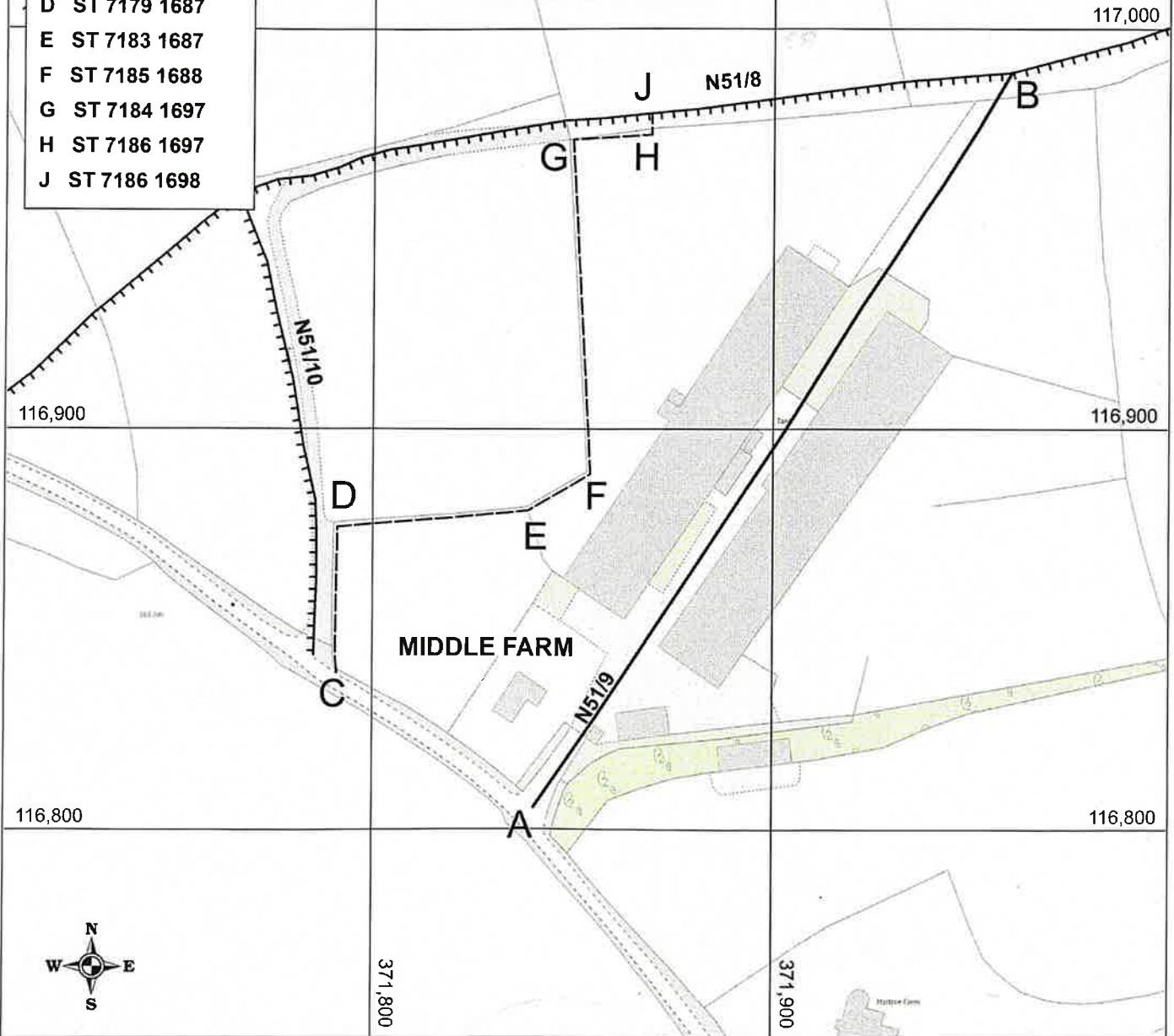

**DORSET COUNCIL (FOOTPATH 9, STALBRIDGE)  
PUBLIC PATH DIVERSION ORDER 2026**

*Dorset Council*

**Ref:P286/25/5**

**Date: 04/03/2026**

**Drawn by: ASB**

**Scale:1:1500@A4**

**Cent X: 371,854**

**Cent Y: 116,935**



© Crown copyright and database rights 2026  
OS 0100060963. Aerial Photography ©  
UK Perspectives 2002 & © Getmapping 2005, 2009  
& 2014. © Getmapping Plc and Bluesky International  
Limited (2017 onwards)